

## MAINTENANCE INSTRUCTIONS CHRONO WITH VISIBLE HINGES

### 1. First

- All gear adjustments, especially of the hinges and the link arm, the replacement of parts and installation and removing of the vents should be carried out by a window expert.
- These maintenance instructions also apply to the other Chrono window systems which are not specifically described here.

### 2. Lubrication

- The corner transmission, handle and mishandling device are greased during manufacture and therefore no additional lubrication is necessary.
- The hinges and locking points are lubricated every year with a light oil.

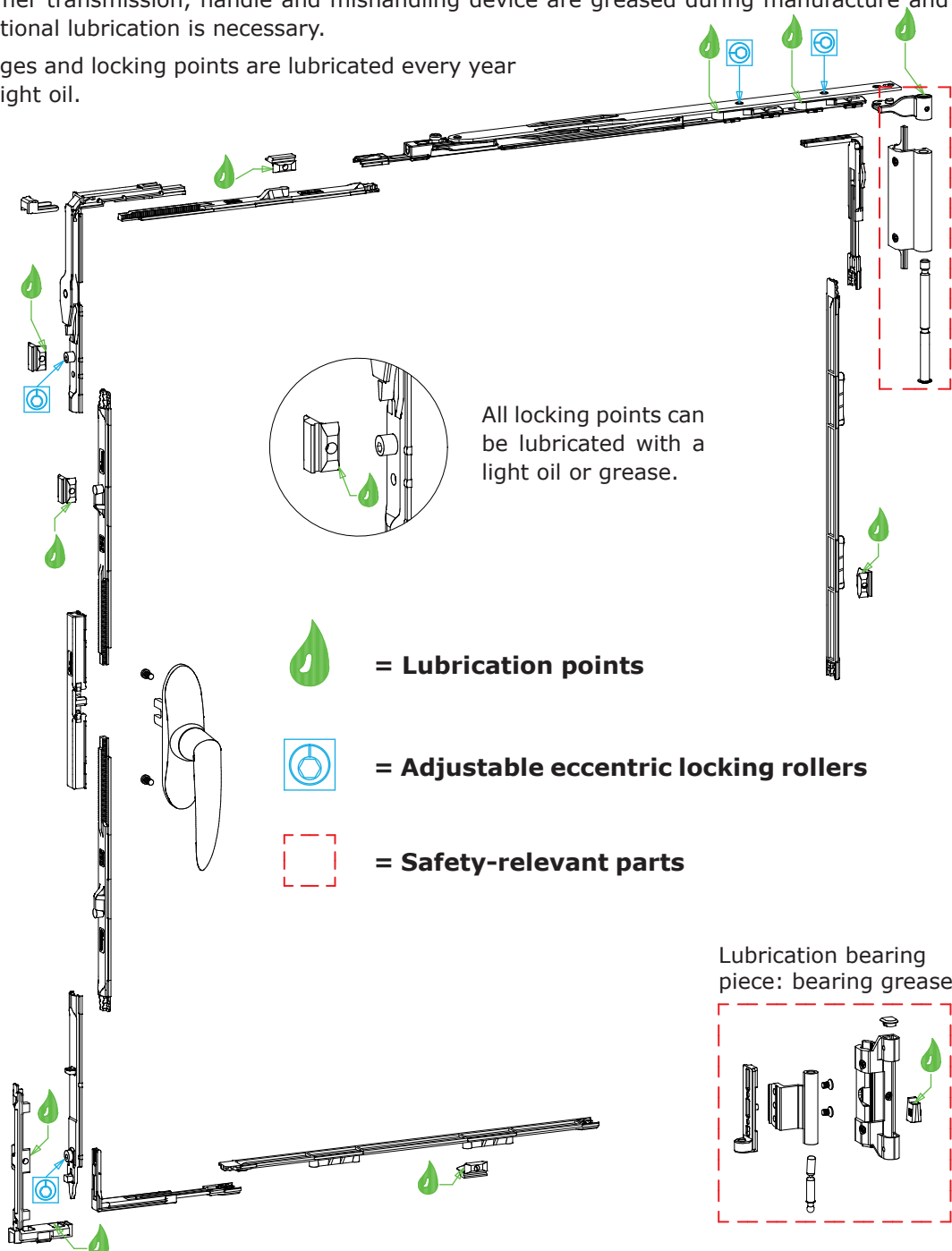

## MAINTENANCE INSTRUCTIONS CHRONO WITH VISIBLE HINGES

### 3. Adjustments

- The following adjustments should be carried out by a window expert.

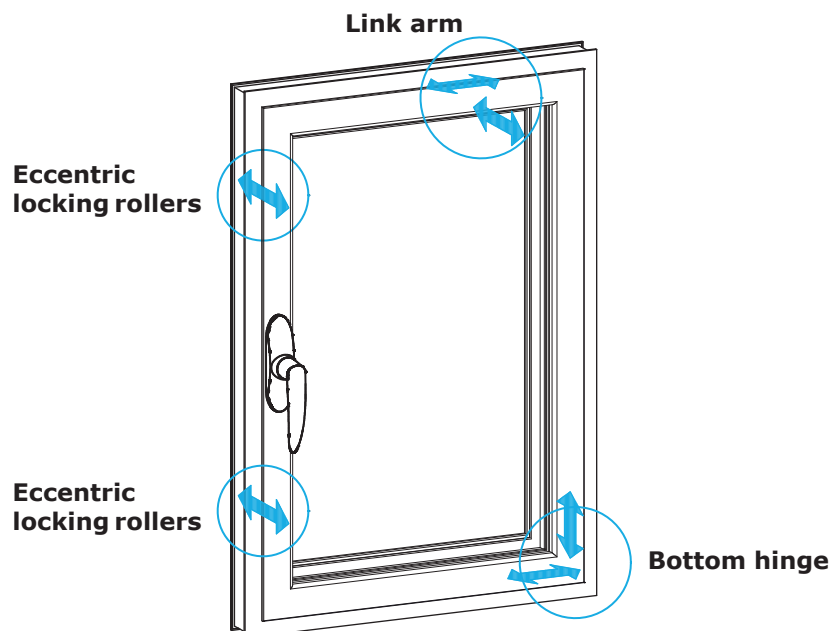

### 4. Adjustable parts

- Note: the adjustment values, with exception of the gasket pressure adjustment, are always based on the inside gap of 21 mm.

#### Eccentric locking rollers

##### Gasket pressure adjustment

- More gasket pressure = +0.8 mm
- Less gasket pressure = -0.8 mm

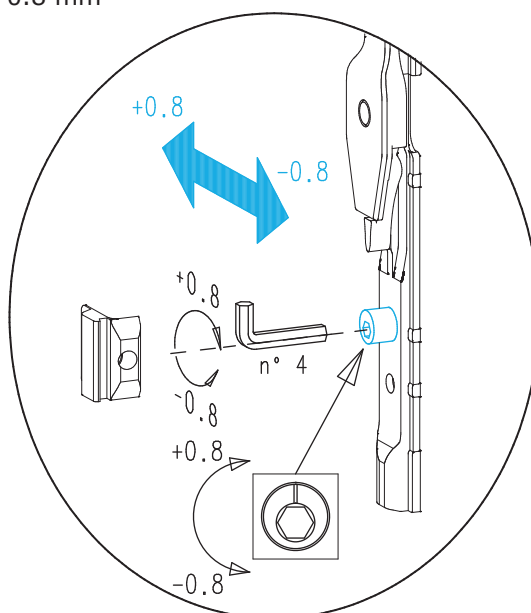

## MAINTENANCE INSTRUCTIONS CHRONO WITH VISIBLE HINGES

### Link arm

#### Lateral adjustment

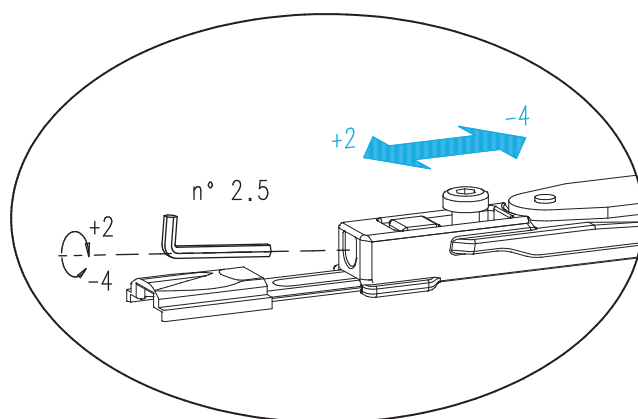

#### Gasket pressure adjustment

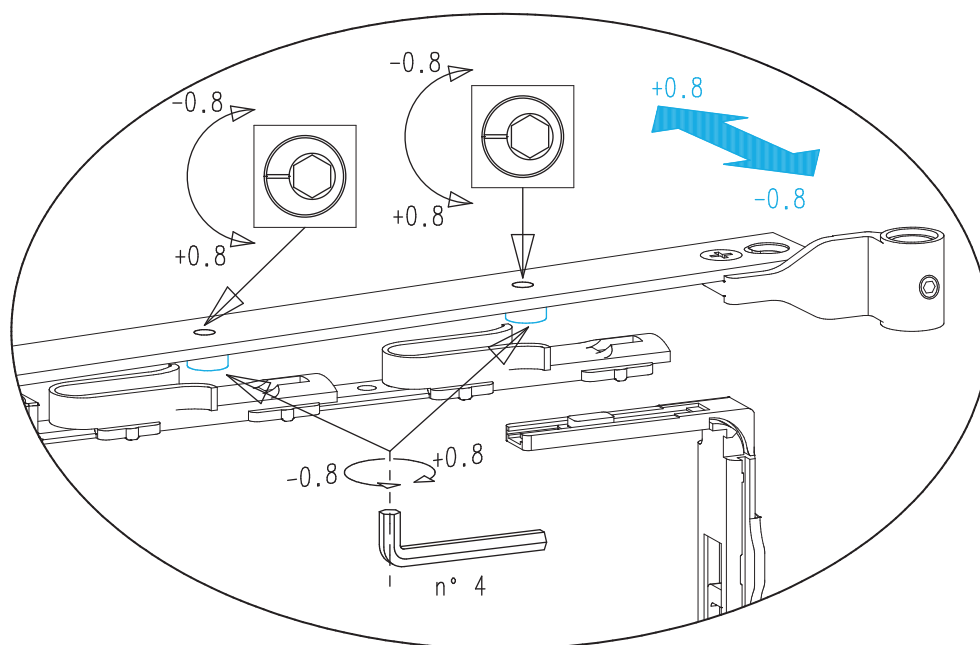

## MAINTENANCE INSTRUCTIONS CHRONO WITH VISIBLE HINGES

### Bottom hinge

#### Height adjustment

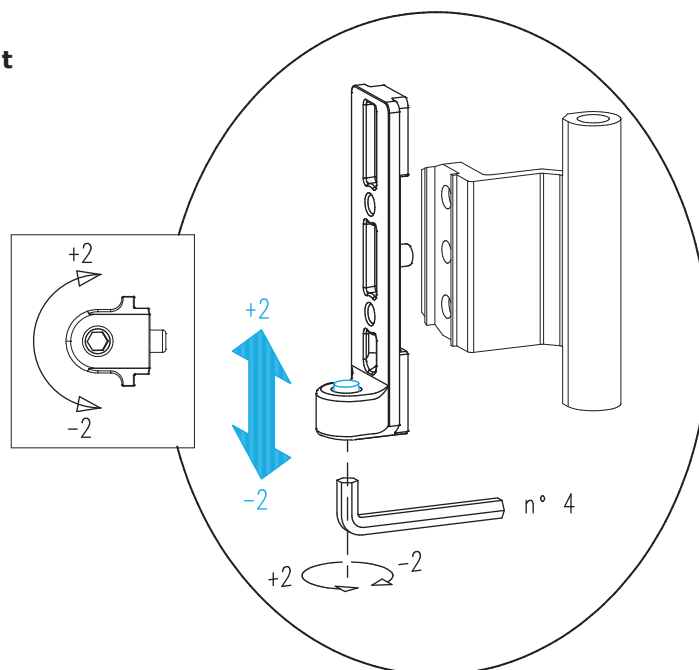

#### Lateral adjustment

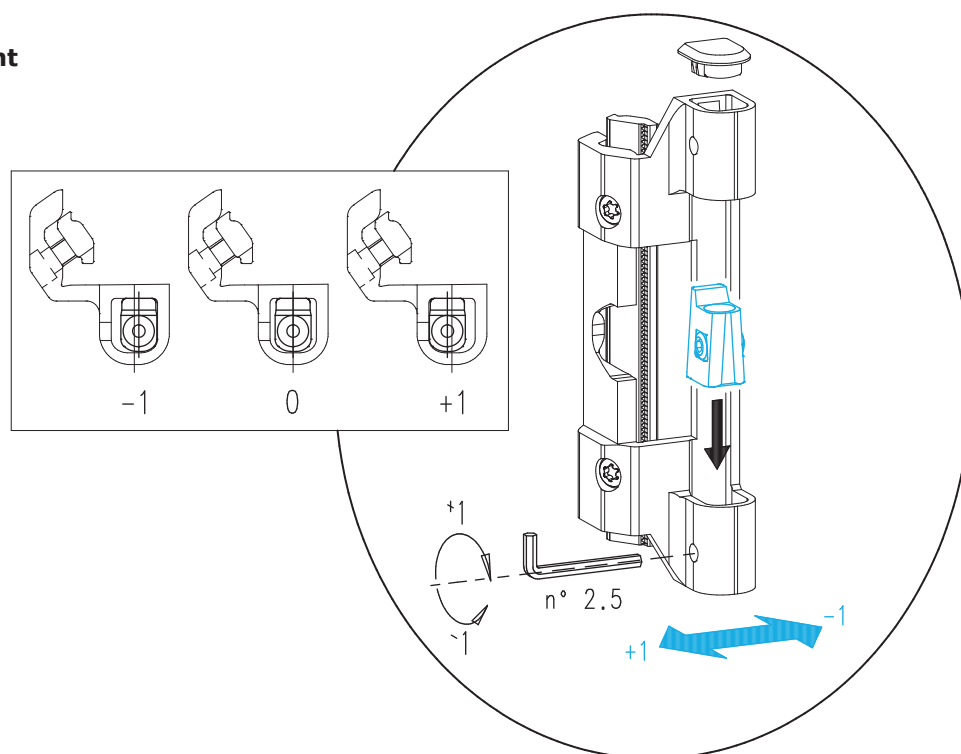

## 5. Additional instructions

- Check operation of the mishandling device. When the window is open, it should not be possible to turn the handle more than a few degrees in both directions. Do not force.
- Check tightness of link arm, handle, hinges and keep screws. Do not attempt to tighten the locking rollers. These are riveted into position during manufacture and are used only for initial adjustment of weather seal compression.
- When cleaning the window you should also remove any dirt from the grooves.
- The windows must be cleaned with water only to avoid corrosion of the fittings.